



## 22/414 Pitt Street Haymarket NSW

2 🛏 2 🚿 1 🚗

Perfectly positioned in one of Sydney's most connected precincts, this residence places you right in the middle of the action. With Central Station, Chinatown, Darling Square, and World Square just moments away, you'll have transport, dining, and shopping options at your doorstep. Whether it's a quick commute, a night out, or a weekend stroll, this address offers unparalleled convenience.

Set high on Level 8 of the renowned Regis Tower, this apartment offers an impressive 122sqm on title. Designed with space and functionality in mind, it combines generous interiors with multiple outdoor living zones, making it a standout choice for city dwellers. It's been freshly updated, giving the interiors a crisp, modern refresh; including fresh

[For full version visit the website](https://www.metrorealty.com.au)

**Type** : Apartment  
**Price** : \$ 1,050,000  
**Land Size** : 122 sqm  
**View** : <https://www.metrorealty.com.au/8560607>



**Joseph Fairchild**  
0425 945 888



**Joe Fairchild**  
0402 696 497

22/414 Pitt Street, Sydney

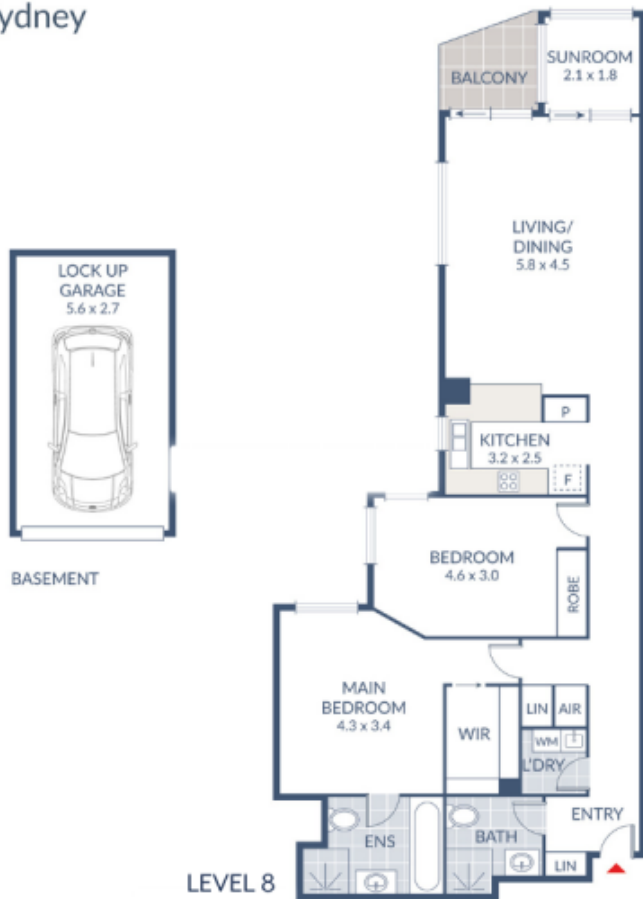

Dimensions are approximate. All information contained is gathered from sources we believe to be reliable. However we cannot guarantee its accuracy and interested persons should rely on their own enquiries.

